

5-HORSE SLANT LOAD

GOOSENECK Living Quarters Shell



Here at 4-Star Trailers, we are experts in horse trailer design and manufacturing. We do what we do best: Design and build safe, durable, user-friendly trailers. When we receive your order for a living quarters trailers, we build the trailer shell to incorporate your desires and the interior conversion company's specifications. We leave the installation of the interior to those experts. Available in 2 to 5 horse slant load models, this 4-Horse began as one of a group of trailers designed specifically to serve as a starting point for creating your next living quarters trailer.

Heretofore, customers configuring LQ trailers were required to start with a base model requiring extensive alteration. We've created a more convenient and economical way for our customers to realize their dream trailer. We bundled options common to most LQ trailers and applied them to our standard models of slant load trailers to create new base models from which to build on; at significant savings to you.

All 4-Star Trailers Come With Our

8 YEAR WARRANTY



STANDARD FEATURES

- 28'-6" L x 7'-6" H x 8'-0" W
- 7000# Torsion Axles
- Electric Brakes
- 16" Aluminum Wheels
- 5 Fourteen Ply Radial Trailer Tires
- 2 5/16" Adjustable Coupler
- Single Speed Drop Leg
- Removable Crank Handle
- Tapered 8'-0" Gooseneck w/Large Slider Window Curb Side, Jalousie Kick Out Window Street Side
- Polished Cast Corner Caps
- Pre-painted White Exterior On Smooth Aluminum
- 8'-0" Short Wall
- Dressing Room Door W/ Window
- Walk Through Door W/ Window and Breast Bar at First Stall
- Large Dropdown Feed Doors W/ Dropdown Window Bars
- Brace For Roof Air
- Holding Tanks
- Propane Bottle Brackets
- Slider Window Each Stall On Hip Wall
- Double Rear Doors w/ Windows
- Permanent Bulkhead Wall
- Smooth Ribbed Aluminum Floor
- Floor Mats Full Length Horse Compartment
- Insulated & Double Walled - Head/ Hip of Horse
- Rubber Lined Walls in Horse Compartment
- Rubber Wheel Wells
- 4 Removable Half Dividers w/ Pads & Holdback
- Two-Way Roof Vent Per Horse
- 2 Trailer Ties Per Horse - Inside & Outside
- 1 Feed Bag Per Stall
- Butt Bar - Curbside Rear
- 5 LED Dome Lights

- Collapsible Rear Tack w/ Removable Post
- Saddle Rack Per Horse - Removable
- 10 Bridle Hooks
- 2 Brush Trays
- 1 Blanket Bar
- High Turn Signals
- Halogen Load Light
- LED Trailer Marker Lighting
- D.O.T. Tape
- Custom Graphics

POPULAR OPTIONS

- Dual Hydraulic Landing Legs
- Air Ride Suspension
- Door In Bulkhead Wall
- Drop Down Doors On Hip
- Electric Hydraulic Brakes
- Feed Mangers
- Integrated Hay Pod
- Lengths Up To 44'
- Additional Height
- Widths Up To 8'-6"
- Porch Light at Dressing Room Door
- Enclosed Drop w/Roll-up Door
- WERM Flooring
- Slide out Room Extension
- Feed Mangers
- Easy Lift Rear Ramp
- Polished Slats, Top Rail
- Stainless Steel Nose



4-Star Trailers, Inc.
 10,000 N.W. 10th St. Oklahoma City, Ok 73127
 800-848-3095 • www.4startrailers.com
 All dimensions are approximate. Photos may show options.

5-HORSE SLANT LOAD

GOOSENECK Living Quarters Shell

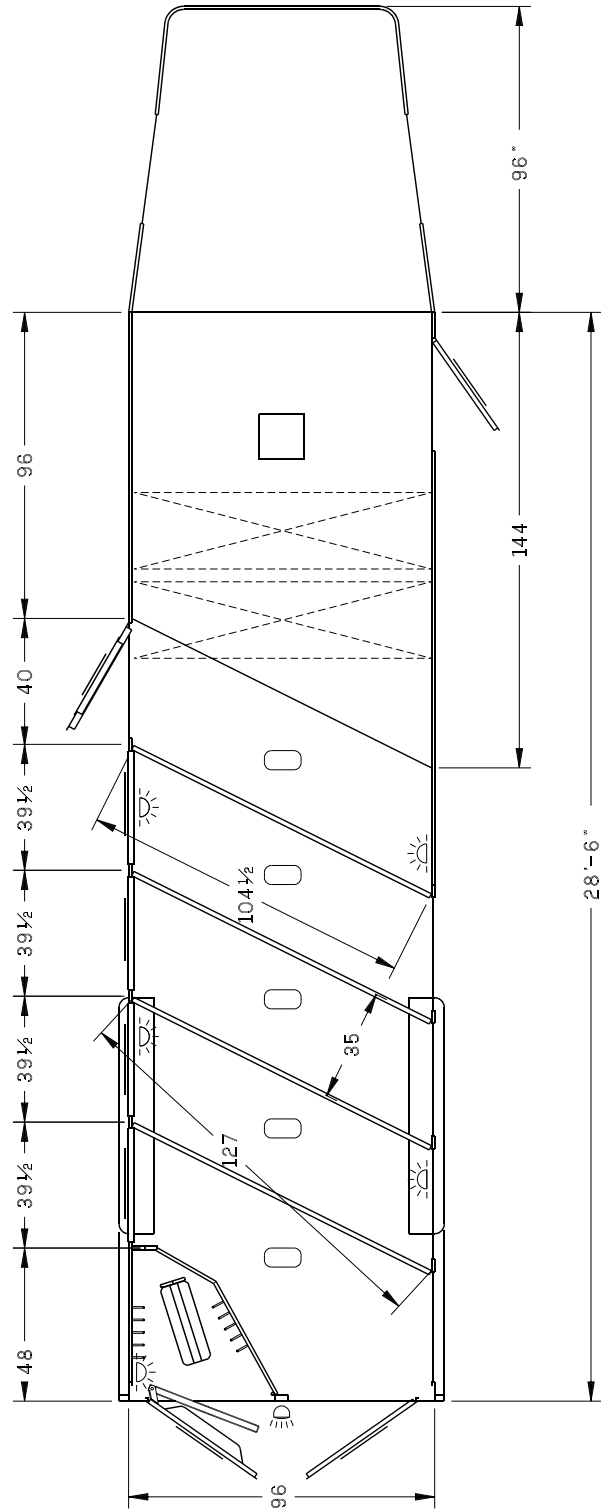

4-Star Trailers, Inc.
 10,000 N.W. 10th St. Oklahoma City, Ok 73127
 800-848-3095 • www.4startrailers.com
 All dimensions are approximate. Photos may show options.